

The 13.6m Liberty unit provides a flexible mobile healthcare environment, built to meet strict NHS standards. Created by linking together twin vehicles, the unit offers: two private consultation rooms, additional treatment areas, a spacious reception and disabled access and toilet facilities. Medical staff using the vehicle have access to a private locker and kitchen area. Easily adaptable and quick to set up, the unit is suitable for a wide range of uses - from a GP or dentist surgery to private health screening, testing and immunisation. Both units are fully air-conditioned.

## Vehicle Features

- Meet NHS standards for infection control and hygiene
- 2 Private consultation rooms
- Additional treatment areas
- Reception and waiting area
- Disabled and staff toilet facilities, plus separate sluice room
- Kitchen facilities
- Full disabled access
- Set-up time 2 hours
- Air conditioning
- Self-contained power supply (2 x 27 KVA generators)
- Fire alarm system / CCTV and intruder alarm
- External floodlighting
- Satellite communications facility
- 10 available on the fleet

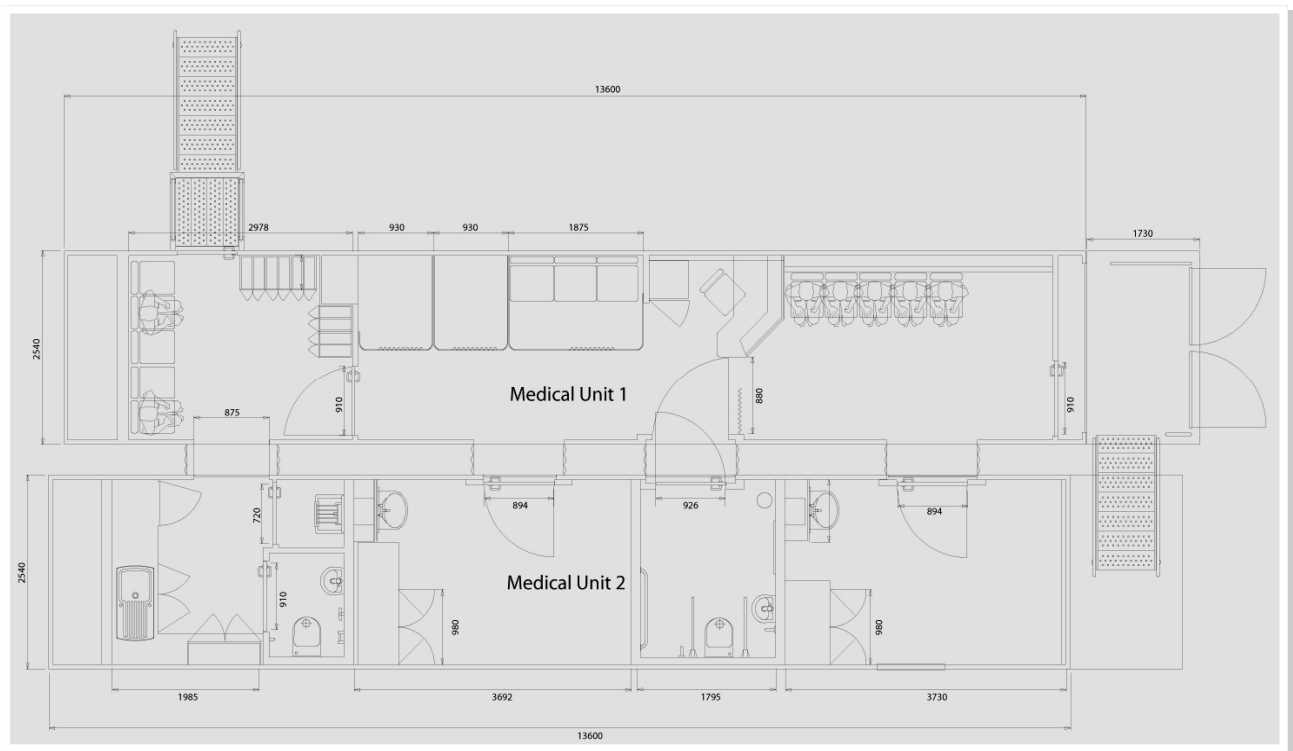
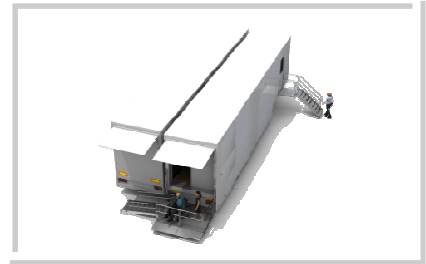

## Sizes and specification

<b>Internal Floor Space</b>	60.8m	<b>Flooring Type / Colour</b>	Lino (brown/green)
<b>Internal Height (main body area)</b>	2.2m	<b>Skirt Colour</b>	n/a
<b>External Height (floor to roof)</b>	4.2m	<b>Internal Walls Colour</b>	White
<b>Vehicle Footprint</b>	15.5m x 9m	<b>External Body Colour</b>	White